

# TRÍMM COPENHAGEN

---

## BRICK SOFA





# BRICK SOFA



Brick sofa is made up of three modules: a pouf-, a space- and a corner module, which can be put together in a myriad of variations via included clip-on holders. You can therefore create exactly the sofa you want - small or large with or without a corner.

The sofa is designed so that it has the same round shapes and voluminous expression as the other furniture in TRIMM Copenhagen's range. It is therefore also the cushions and pillows themselves that are the central element in the sofa. In addition, the sofa is created with an external metal frame that helps to give the sofa a lightness and a more mature expression.

The sofa should be seen as an extension of TRIMM Copenhagen's lounge universe, which with its very own design language invites to informal gatherings between people.

## Dimensions:

Brick Corner Module: D: 93 x W: 93 H: 74 cm – Seat: 37 cm

Brick Space Module: D: 93 x W: 81 H: 74 cm – Seat: 37 cm

Brick Pouf Module: D: 81 x W: 81 H: 37 cm

**Cushion material:** Sunbrella Plus®

**Frame material:** Powdercoated Stainless Steel

**Filling:** A mix of Silicone & EPS beads

**Frame Color:** Dark Metal Grey

Clip-on holders included

## Colors:



Beige

Taupe

Grey

Graphite



# ASSEMBLY INSTRUCTIONS



Brick Corner Module

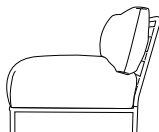

Brick Space Module

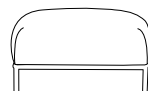

Brick Pouf Module



Brick Space Module: Place the two arms on the backrest in the holes of the seat construction.



Brick Corner Module: Place the three arms on the backrest in the holes of the seat construction.

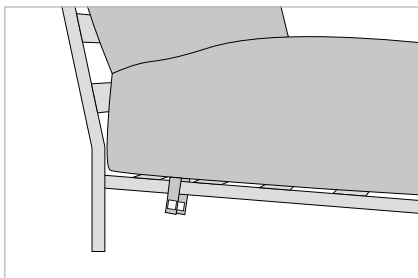

Cushion fastening: Place the seat cushion on the frame and open the velcro straps.

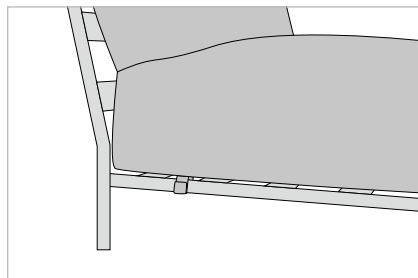

Cushion fastening: Wrap the velcro straps around the frame pipe to secure the cushion.

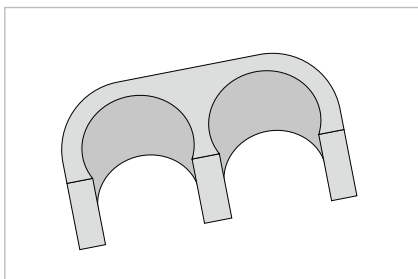

Module attachment: If you have more than one module, they can be attached with a clip.

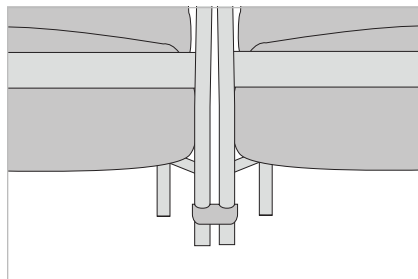

Module attachment: Place the two modules close together and put the clip each module where you find suitable.



